

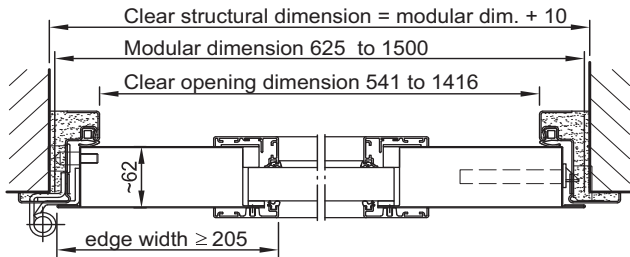

Highly flame-resistant steel door EI₂60-C5-S_a „Teckentrup 62“ 1lf. door

Fire resistant door acc. to EN 16034 (interior doors | national registrations)

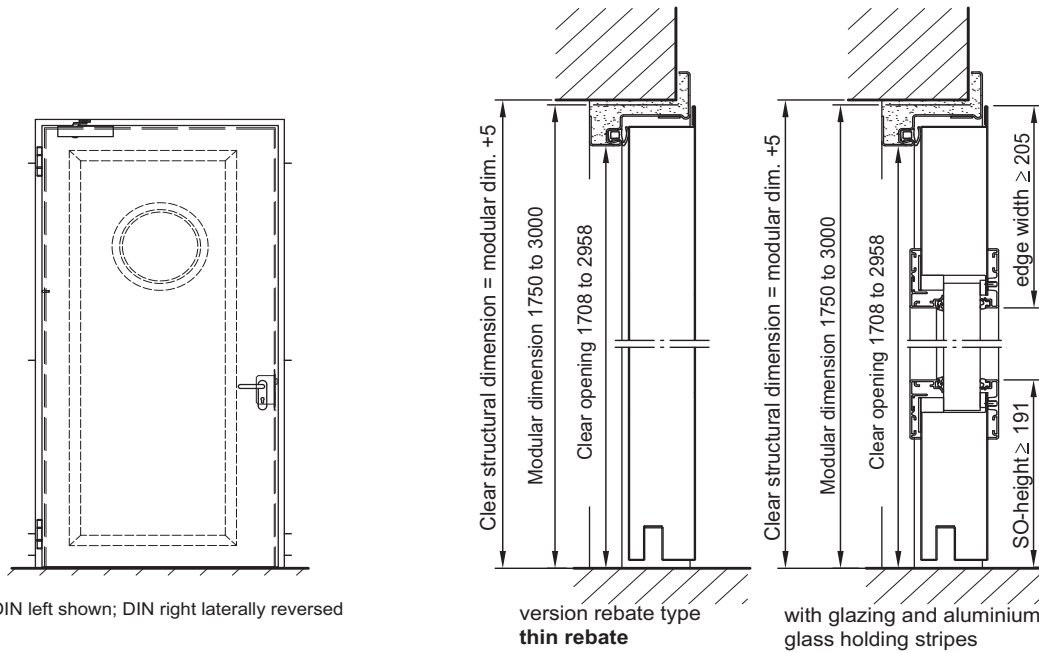

Floor connections:

- Image 1: with bottom buffer
- Image 2: with bottom buffer/seal
- Image 3: with retractable bottom seal
- Image 4: with sliding threshold seal

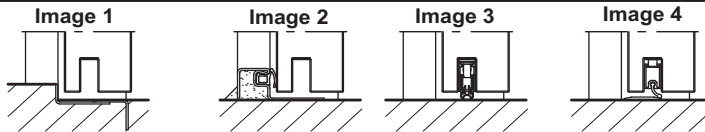

**Installation in masonry/
concrete walls**
wall thickness ≥ 115 mm

Exposed masonry mounting

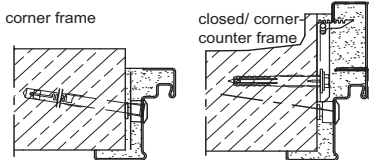

flush edge installation

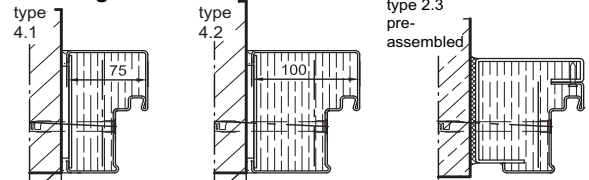

**Installation in aerated
concrete walls**
wall thickness ≥ 150 mm

Exposed masonry mounting

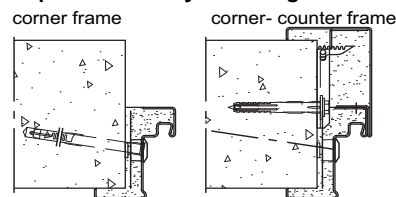

Assembly walls

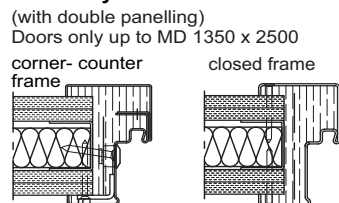

**Installation in concealed
steel support**

