

CarTeck DRIVE^{CE}

You might see from time-to-time over the life of a garage door that the door stops before sealing against the floor. There's a simple fix, resetting the doors' operator.

Watch Dan take you through the reset procedure on the CarTeck DRIVE sectional garage door operator step-by-step or read the written instructions below...

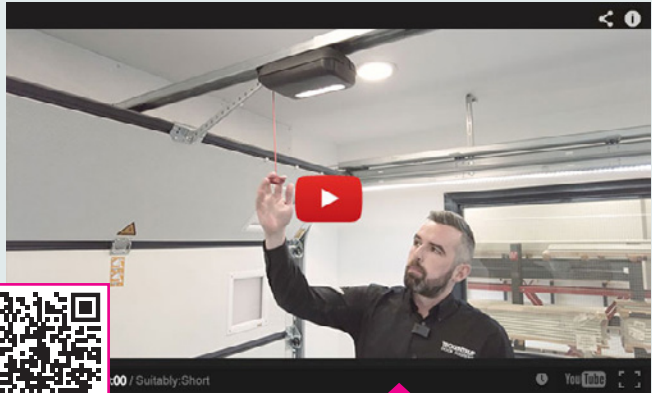

SCAN THE QR CODE TO WATCH THE VIDEO!

Step 1

First, position the door halfway open – this is done by disconnecting the drive from the door leaf by pulling the red emergency release/manual override cord and manually moving the door into position. Once halfway open, pull the cord again to re-engage the motor, move the door slightly back and the motor will 'click' to confirm it is reconnected.

Step 2

Remove the plastic cover from the operator head (this is the part of the drive that travels up and down the rail) by pressing in the release clip at the back.

Step 3

Once the cover is removed, a force reset is carried out by holding down the green button at the front of the operator head for 30 seconds – a green LED will go through a series of flashing sequences before going out. At this point, release the button, and then press the transmitter/remote control button once and the door will then open fully.

Step 4

Now fully opened, push the button on the transmitter/remote control once again and the door will close.

Step 5

Once the door has fully closed, push the transmitter/remote control button a final time and the door will then open and close several times on its own as it learns the force values.

Step 6

When the door stops opening and closing, the programming is complete.

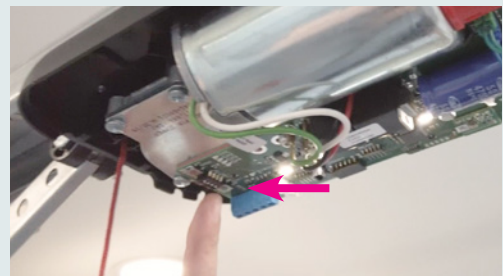
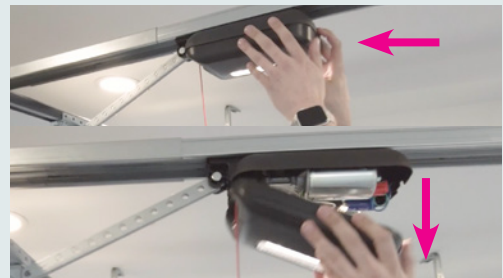

ORDER TODAY!

Call the team on: **01925 924 050**

Teckentrup UK Limited, Units 2-4 Opus 9 Industrial Estate,
Woburn Road, Winwick Quay Warrington WA2 8UE
t: 01925 924 050 f: 08701 314 843 e: sales@teckentrup.co.uk

WWW.TECKENTRUP.CO.UK

TECKENTRUP
DOOR SOLUTIONS