



Fire-Resistant Steel Trap / Steel Door

E_{1,90}-C5-S_a „Teckentrup 62“ 1lf. Outside door

Fire-resistant as outside door - classification with CE-labelling (acc. to EN 16034 / 14351-1)

Text example:

E_{1,90}-C5-S_a classification fire-resistant closure as outside door with CE-labelling (acc. EN 16034 / 14351-1). Single leaf door element. Type of handling DIN right. Flush door leaf with thin rebate, 62 mm thick, rebated on 3 sides. Corner frame 1,5 mm thick with 3-sided seal, without floor recess. Door leaf and frame galvanized and prime coated similar to RAL 9002 (Grey white). Mortice lock with latch lever in accordance with DIN 18250, prepared for profile cylinder. Black plastic round handle set. DHandle pivoted on bearing, with tumbler insert (Bb) and 1 Bb key. 1 security bolt. 1 spring hinge and 1KO hinge with ball bearings. „Teckentrup 62“ or equivalent.

Compile and tender according to requirements. Please refer to technical data below for respective details. Updated 01.11.2019)

Technical data

Also available in **STAINLESS STEEL!**

Classification	E _{1,90} -C5-S _a classification fire-resistant closure as outside door with CE-labelling (acc. EN 16034 / 14351-1)	
Installation in	<ul style="list-style-type: none"> ▪ Masonry wall min. 175 mm ▪ Concrete wall min. 140 mm ▪ Aerated concrete <ul style="list-style-type: none"> - Autoclaved aerated concrete min. 175 mm - Reinforced AAC walls min. 175 mm 	
Approved dimensions (thin rebate)	Modular dimension	W 500 - 1500 mm H 500 - 3000 mm
	with top light/ top casing up to	H 4000 mm
Approved dimensions (thick rebate)	Modular dimension	W 625 - 1500 mm H 1750 - 3000 mm
Type of handling	DIN right or DIN left	
Door leaf	Double skinned: thin rebate, thick rebate	
	Trap:	4-sided rebated
	Door:	3-sided rebated
	Thick rebate door:	62 mm
	Sheet thickness:	1,0 mm or 1,5 mm
	Security bolt:	min. 2
Frame	<ul style="list-style-type: none"> ▪ Corner frame 1,5/2,0 mm thick, trap door 4-sided ▪ Door 3-sided with seal ▪ Door without floor recess fitted ▪ Fastening by exposed masonry mounting Special Equipment: <ul style="list-style-type: none"> ▪ Block-, counter- or closed frame ▪ Frame with floor recess fitted 	
Floor closure	<ul style="list-style-type: none"> ▪ Retractable bottom seal ▪ Sliding threshold ▪ Buffer strip and seal Floor seal retrofittable. 	
Surface	Door leaf/Frame galvanized and prime coated, similar to RAL 9002 (Grey white). Special equipment: <ul style="list-style-type: none"> ▪ RAL of choice 	
Hinges and closing devices	<ul style="list-style-type: none"> ▪ 1 spring hinge and 1 CO hinge or ▪ 2 CO hinges and 1 top door closer ▪ Compensation rings for height adjustment 	
Fittings	<ul style="list-style-type: none"> ▪ Mortise Lock prepared for profile cylinder ▪ Black plastic handle set, handle pivoted on bearing with tumbler insert.(Bb) and 1 Bb-key. 	
Verglasung	Fire resistant glass, clear F1-90, glazing area angled with aluminium glass holding strips. Max. pane size 1000 x 2263 mm. Round glazing (Ø 300, 400 and 500) with steel glass holding strips galvanized and prime-coated, grey-white similar to RAL 9002. Special equipment: <ul style="list-style-type: none"> ▪ Rectangular glazing, aluminium glass holding strips in stainless steel design / rectangular/ round glazing stainless steel glass holding strips 	

Required for doors für outside use:	<ul style="list-style-type: none"> ▪ Floor closure ▪ Rain guard top (necessary if no roof/canopy existing) ▪ Weather board at the bottom (recommended)
--------------------------------------------	-----------------------------------------------------------------------------------------------------------------------------------------------------------------------------------------

Special equipment	<ul style="list-style-type: none"> ▪ Handle sets/lever/knob sets: <ul style="list-style-type: none"> - Plastic - Light metal - Stainless steel - With short plate or rose escutcheon (various makes) ▪ Prepared for rose escutcheon ▪ Panic bar ▪ Locks <ul style="list-style-type: none"> - Panic locks - Block lock (must be provided) ▪ Profile cylinder 40,5 + 40,5 mm (thin rebate) ▪ Profile cylinder 45,5 + 35,5 mm (thick rebate) ▪ Top door closer <ul style="list-style-type: none"> - hinge/opposite hinge side - with slide rail ▪ Electric door opener ▪ Integrated lock inspector (bolt contact) ▪ Integrated opening indicator (reed contact)
--------------------------	--------------------------------------------------------------------------------------------------------------------------------------------------------------------------------------------------------------------------------------------------------------------------------------------------------------------------------------------------------------------------------------------------------------------------------------------------------------------------------------------------------------------------------------------------------------------------------------------------------------------------------------------------------------------------------------------------------------------------------------------------------------------------------------------------------------------------------------------------------------------------------------------------------------------------------------

	Ordering dimensions / modular dimensions width x height	Clear passage sizes (corner frame) width x height
Standard sizes	875 x 2000	791 x 1958
	2125	2083
steel door	1000 x 2000	916 x 1958
	2125	2083
	1125 x 2000	1041 x 1958
	2125	2083
	1250 x 2000	1166 x 1958
	2125	2083
	2250	2208

(Special sizes: from 500 x 1750 to 1500 x 4000)

Further qualifications (Special equipment):



Smoke proof in accordance with EN 1634-3 with top door closer, for solid walls



Sound insulated in accordance with EN 20140/717 Teil 1 up to **RW 42 dB** (thin rebate) up to **RW 42 dB** (thick rebate) depending on door structure and bottom seal



Burglar resistant in acc. with EN 1627 - **RC 2, RC 3, RC 4** (thin rebate) **RC 2, RC 3** (thick rebate)

Fire-Resistant Steel Trap / Steel Door
EI₂90-C5-S_a „Teckentrup 62“ 1lf. Outside door

Fire-resistant as outside door - classification with CE-labelling (acc. to EN 16034 / 14351-1)

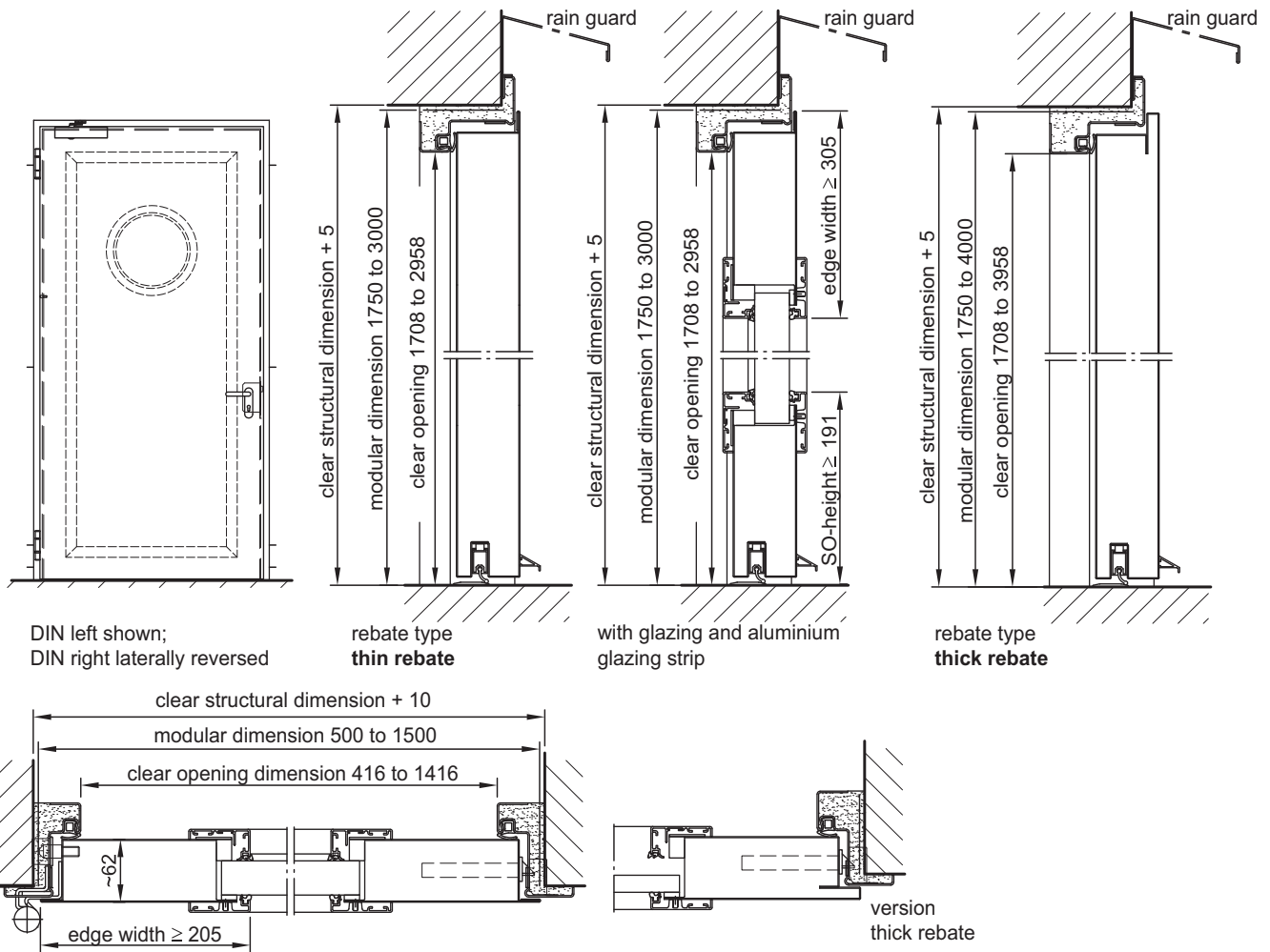

Floor connections:

- Image 1: with bottom buffer
- Image 2: with bottom buffer/seal
- Image 3: with retractable bottom seal (smoke-proof door with top door closer)
- Image 4: with sliding threshold seal

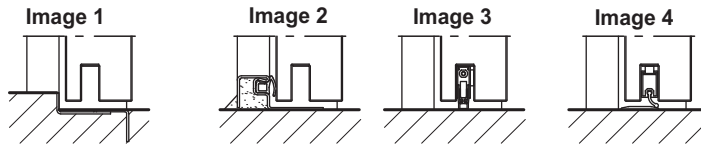

Installation in masonry/ concrete walls
concrete walls ≥ 140 mm
masonry walls ≥ 175 mm

Exposed masonry mounting

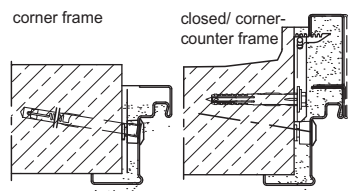

Flush edge installation

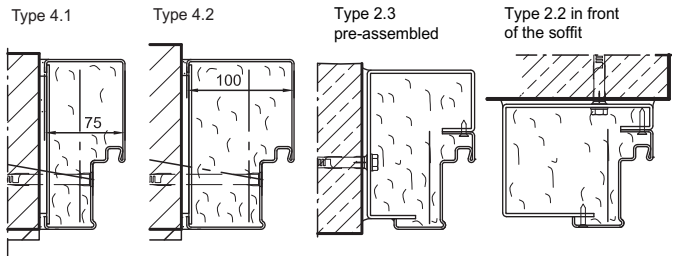

Installation in autoclaved aerated concrete walls
(doors with top door closer)
Made of auto. aerated concrete blocks or reinforced auto. aerated concrete thickness min. 175 mm

Exposed masonry mounting

