



Fire-resistant all-glass door T 30-2-FSA „Teckentrup GL“

Frameless glass door, with retractable bottom seal

Text example:

T 30-2-FSA All-glass door tested in acc. with EN 1634-1. Frameless double leaves glass-door. Door leaf 27 mm thick. Corner frame 1.5 mm thick with 3-sided seal, without floor recess. Fitting covers made from stainless steel 1.4301, grinded with grain size 240. Frame vgalvanized and prime coated in traffic white RAL 9016. Standard gass door lock with latch lever prepared for PC. FP-round handle set, stainless steel. 2 VN-all glass-fire protection hinges with stainless steel cover. Dorma TS 93 with integrated door selector, Stainless steel type mounted on hinge side. „Teckentrup GL“ or equivalent.

(Compile and tender according to requirements. Please refer to technical data below for respective details. Updated 01.02.2021)

[Text T30-2 GL online](#)

Technical data

Technical approval	Z-6.20-2184 tested for installation in internal walls
Installation in	<ul style="list-style-type: none"> ▪ Masonry min. 175 mm ▪ Concrete min. 140 mm ▪ Autoclaved aerated concrete (AAC) <ul style="list-style-type: none"> - AAC stones min. 175 mm - reinforced AAC min. 175 mm ▪ Lightweight construction stud wall* min. 100 mm <p>* only possible with approval in individual cases. Technical clarification required in advance.</p>
Approved dimensions	Modular dimension W 1375-2500 mm H 1750 -2500 mm
Type of handling	DIN right or DIN left
Door leaf	Door leaf thickness: approx. 27 mm
Frame	<p>Corner frame 1.5 mm thickness with 3-sided seal, without floor recess. Fastening by exposed masonry mounting.</p> <p>Special equipment:</p> <ul style="list-style-type: none"> ▪ corner-, counter frame ▪ closed frame ▪ block frame type 4.1 or block frame type 4.2
Bottom seal	▪ standard with retractable bottom seal
Surface	<ul style="list-style-type: none"> ▪ Stainless steel fitting covers 1.4301, smooth 240 grain size ▪ frame galvanised and prime coated, traffic white similar to RAL 9016 <p>Special equipment:</p> <ul style="list-style-type: none"> ▪ Frame in RAL of choice ▪ Stainless steel frame
Hinges and closing devices	<ul style="list-style-type: none"> ▪ 4 pcs.VN-all-glass-fire-protection-hinges with stainless steel cover ▪ Dorma TS 93 with slide rail in Contur-design. Stainless steel, mounted on hinge side
Fitting	<ul style="list-style-type: none"> ▪ Standard glass door lock with lever/knob prepared for profile cylinder ▪ FP- round handle set V2A fire-resistant stainless steel round handle set

Special equipment

- Panic- / bar handle
- Locks
 - panic locks
- Profile cylinder 55 + 26.5 mm
- Top door closer
 - hinge-/opposite hinge side
- Door drive
- Film coating on the glass

	Ordering dimensions / Modular dimension width x height	clear passage size (corner frame) width x height
Standard sizes	1750 x 2125	1666 x 2083
	2000 x 2000	1916 x 1958
	2125	2083
	2125 x 2125	2041 x 2083
	2250 x 2250	2166 x 2208
	2500 x 2500	2416 x 2458

(special sizes: from 1375 x 1750 mm up to 2500 x 2500 mm)

Further qualifications
(Special equipment):



Smoke proof acc. EN 1634-3 for solid walls and lightweight construction stud walls



Fire-resistant all-glass door T 30-2-FSA „Teckentrup GL“

Frameless glass door, with retractable bottom seal

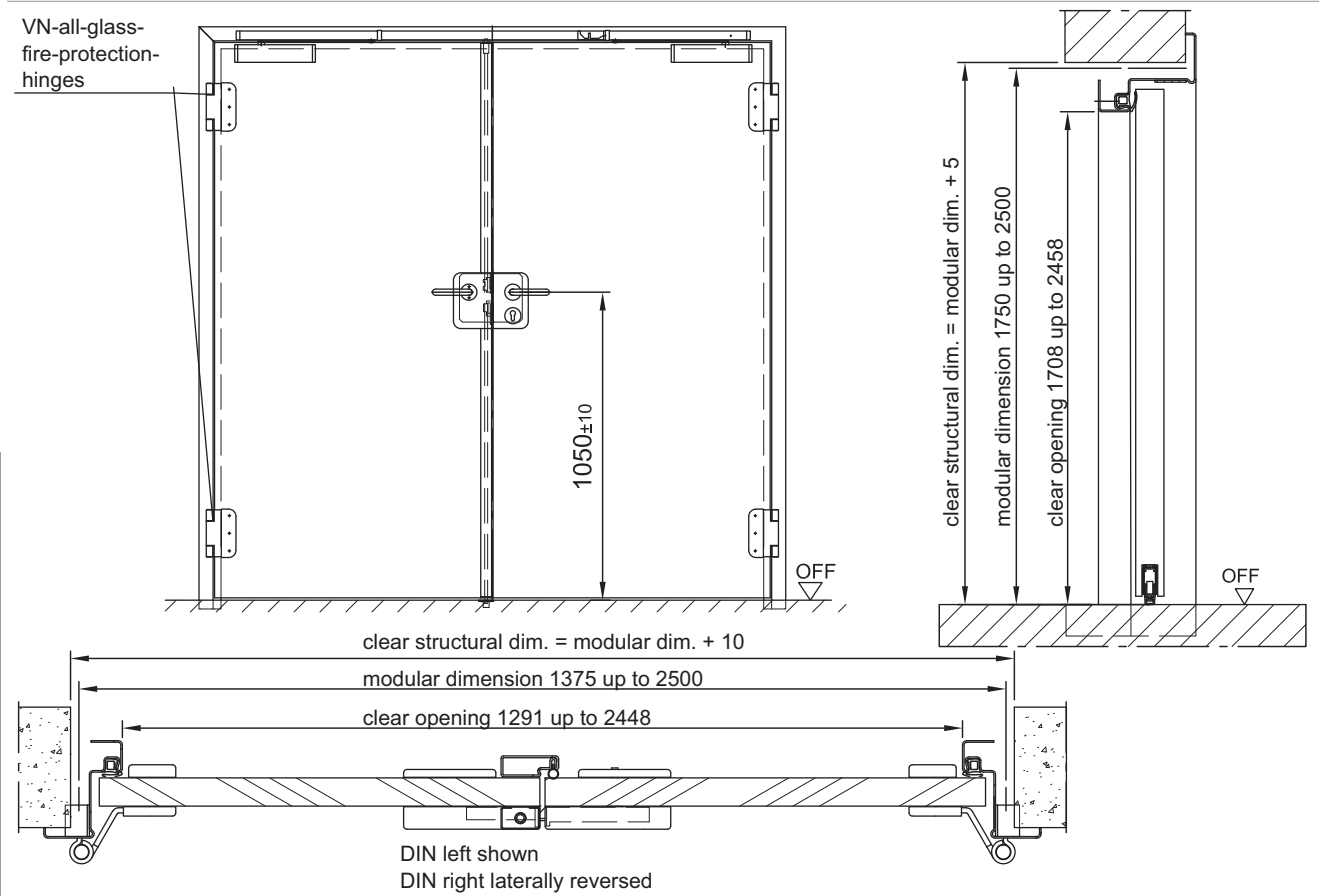

Floor connections
Image 1: with retractable bottom seal

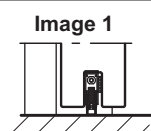

Installation in masonry-/concrete walls
Concrete wall ≥ 100 mm
Masonry wall ≥ 115 mm

Wall plug assembly

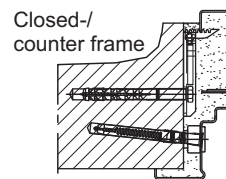
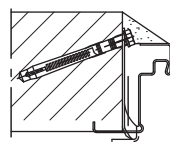
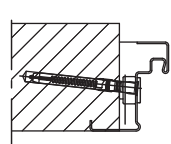

Installation in concrete-corner frame

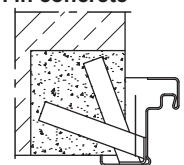

Installation with block frame
Flush edge installation between
Concrete wall ≥ 100 mm
Masonry wall ≥ 115 mm

Type 4.1

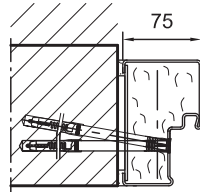

Type 4.2

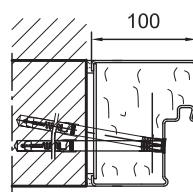

Installation in autoclaved aerated concrete walls
Made of aerated concrete blocks or blocks according to DIN 4165 strength class 4, or of reinforced aerated concrete slabs strength class 4.
Wall thickness min 175 mm

Wall plug assembly

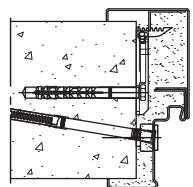
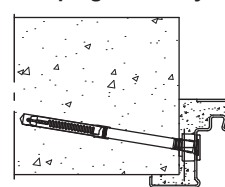

Corner frame

Corner- / counter frame

Fitting in assembly walls

(lightweight construction stud walls)
assembly walls F 90 in acc. with general building authority test certificate.
On request!

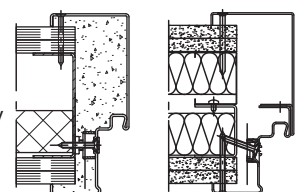

Closed frame / corner-counter frame