

Steel door dw 62-1 „Teckentrup“

Steel door dw 62-1 „Teckentrup XL“

optionally with glazing, optionally with upper casing



Text example

Compile and tender according to requirements.
Please refer to technical data below for respective details.
Updated 1st June 2015



Position	No. of pieces	Item	Unit price €	Total price €
		Heat-insulated single-leaf steel door dw 62-1, double-skinned, filled with mineral wool. Type of handing DIN right. Flush mounted door leaf with less protruding hinges. Door leaf/Frame galvanized and prime coated similar to RAL 9002 (Grey white). 62 mm thick, rebated on 3-sides. Corner frame 1.5 mm/2 mm thick, with 3-sided seal. Mortice lock with latch lever, prepared for profile cylinder. Black plastic handle set. Handle pivoted on bearing, with tumbler insert (Bb) and 1 Bb key. 1 security bolt, 2 KO hinges. „Teckentrup“ or equivalent.		

Technical data

Product: dw 62-1 door „Teckentrup“
Heat insulation as per EN ISO 12567-1 (doors without glazing) $U_D = 1.3 \text{ W/m}^2\text{K}$

dw 62-1 door „Teckentrup XL“

Installation in:

- Masonry
- Concrete
- Autoclaved aerated concrete
- Lightweight construction wall

Dimensions: dw 62-1 door „Teckentrup“
Width: 625 - 1500 mm
Height: 1750 - 3000 mm
dw 62-1 door „Teckentrup XL“
Width: 625 - 1500 mm
Height: 3001 - 4000 mm

Type of handing: DIN right or DIN left

Door leaf: Double-skinned rebated on 3 sides
Door leaf thickness: 62 mm
Sheet thickness „Teckentrup“: 0.75/1/1.5 mm
„Teckentrup XL“: 1.5 mm
Security bolts: min. 1

Frame: dw 62-1 door „Teckentrup“
Corner frame, 1.5 mm thick, with 3-sided seal and bottom sill. Frame fixed with 3 screws per side.
dw 62-1 door „Teckentrup XL“
Corner frame 2.0 mm thick, with 3-sided seal and bottom sill. 3 wall anchor plugs on each side.

Special equipment:
Block, counter or closed frame

Surface: Galvanized and prime coated door leaf/frame similar to RAL 9002 (Grey white)
Special equipment:
• Stainless steel

Hinges: dw 62-1 door „Teckentrup“
• 2 KO hinges with ball bearings
• Compensation rings for height adjustment
dw 62-1 door „Teckentrup XL“
• 2 KO hinges (4 mm) with ball bearings from MD-width > 1350 or MD-height > 3000 mm with 3 KO hinges

Fittings:
• Mortice lock with latch lever, prepared for profile cylinder
• Black plastic handle set, handle pivoted on bearing, with tumbler insert (Bb) and 1 Bb key

Glazing:

Standard glazing:
wire reinforced glass with LM glazing strips
• Type A = 545 x 345 mm
max. glass pane size up to 0.5 m²
Special glazing:
• Round glazing (steel/stainless steel ring)
• Cut-out of choice with LM glazing strips
max. glass pane size up to 1.5 m²

Glazing:
• VSG laminated safety glass 6 mm
• acrylic glass 8 mm
• ISO glass VSG/VSG 21 mm
• ISO glass, wire reinforced/VSG 21 mm

Special equipment:

- Handle sets / Lever/Knob sets:
• plastic light metal
• stainless steel with short plate or rose escutcheon (various makes) with fixed outer knob
- Locks:
• profile cylinder 40.5 + 40.5 mm
• panic locks
- Top door closer DIN EN 1154
• concealed slide rail-door closer ITS 96
- Floor seals
- Rectangular glazing (special size)
- Aluminium ventilation grille
- Steel transformer grille
- Upper casing
- Upper casing with glazing or grille
- Aluminium rain guard

	Ordering size/ Modular dim. width x height	Clear opening size (corner frame) width x height
Standard sizes: dw 62-1 „Teckentrup“	750 x 2000	666 x 1958
	875 x 1875	791 x 1833
	2000	1958
	2125	2083
	1000 x 2000	916 x 1958
	2125	2083
	1125 x 2000	1041 x 1958
	2125	2083
	1250 x 2000	1166 x 1958
	2125	2083
2250	2208	

Further qualifications (special equipment):

Sound insulated as per DIN EN 20140/717-1
Rw 37 dB with retractable bottom seal
Rw 35 dB with sliding threshold seal
Rw 37 dB with bottom buffer and seal



Steel door dw 62-1 „Teckentrup“

Steel door dw 62-1 „Teckentrup XL“

optionally with glazing, optionally with upper casing



Steel door dw 62-1 „Teckentrup“ up to 1350 x 3000 mm
 Steel door dw 62-1 „Teckentrup XL“ from 625 x 3001 mm to 1500 x 4000 mm

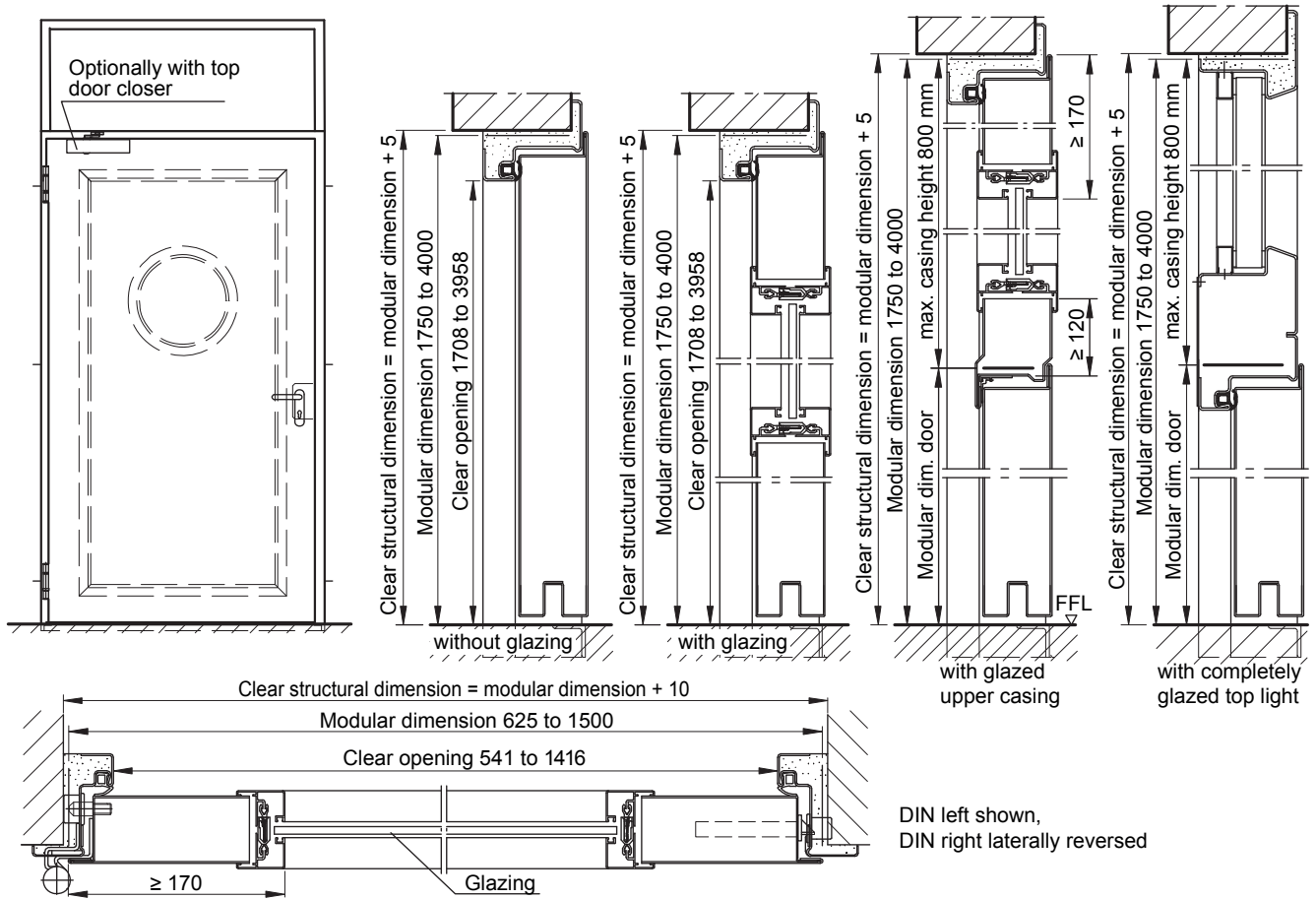

Floor connections:

Image 1: with bottom buffer
 Image 2: with bottom buffer/seal
 Image 3: with retractable bottom seal (smoke-proof door with top door closer)

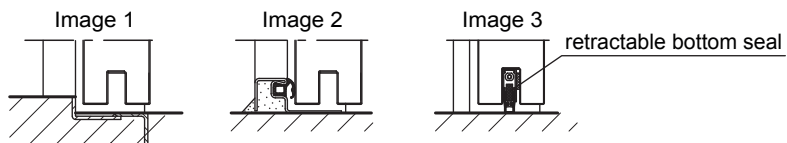

Installation in masonry/ concrete walls

Attention!
 Installation dw 62 „Teckentrup“ shown: frame fixed with screws (dw 62 „Teckentrup XL“ : frame fixed with wall anchor plugs)

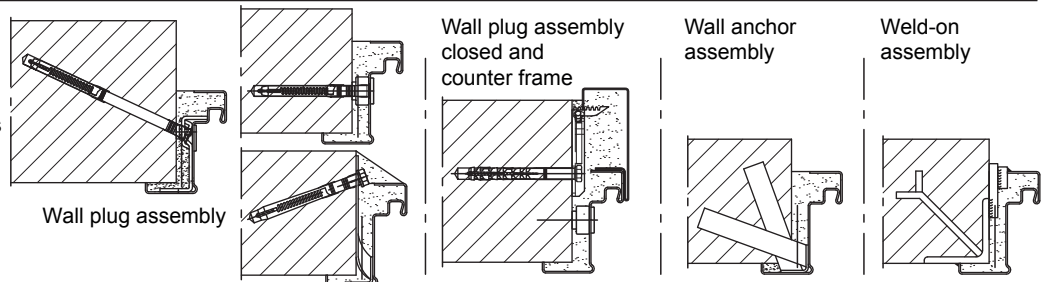

Installation with block frame

as flush installation between masonry or concrete walls

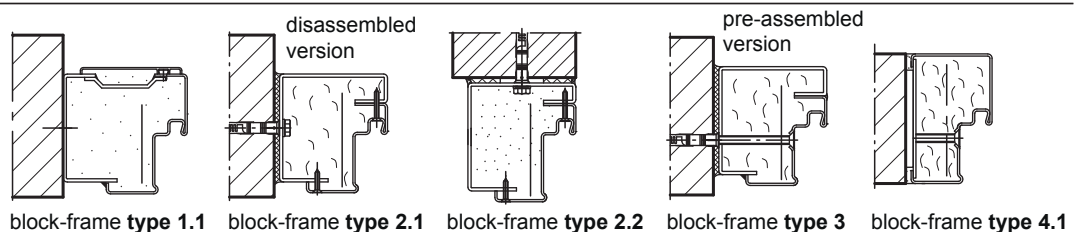

Installation in autoclaved aerated concrete walls

Wall plug assembly

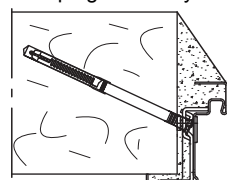

Installation in lightweight stud walls

Installation dw 62 „Teckentrup“ shown

